

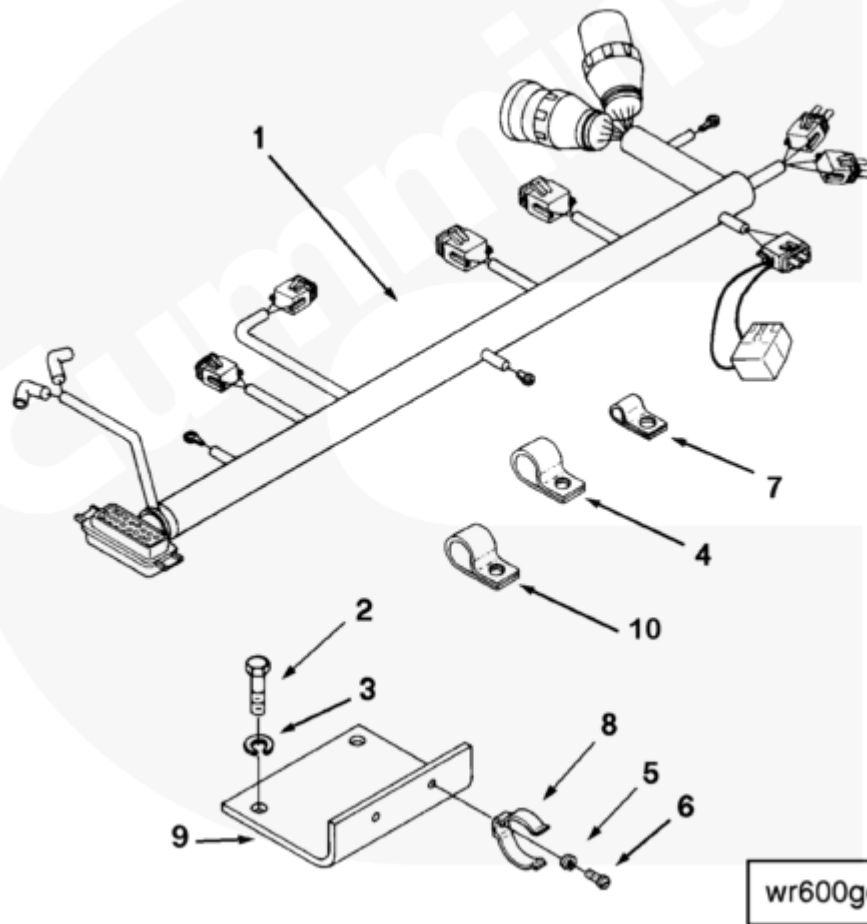

## Parts Catalog - Option Detail

Electronic Parts Catalog - Option Detail				
Option	Group	Graphic	Film Card	Date
WR6001-01	21.02	wr600ge	K38	20-NOV-00
<b>Engines</b>	GTA38, K38, KTA38GC CM558, QSK38 CM2150 K106, QSK38 CM2150 MCRS, QSK38 CM850 MCRS			

©Cummins Inc



[SMALL](#) | [MEDIUM](#) | [LARGE](#)

Cart	Ref No	Part Number	Part Description	Required	Remarks
<input type="button" value="View My Cart"/>					
		<a href="#">WR6001-01</a>	Wiring Accessories		<a href="#">Accessories, wiring...(More)</a>
					Wiring harness for centry
					fuel management
					System for use with voltage

					throttle.
					Includes harness and harness
					mounting hardware for use
					with fuel pump mounted ECM.
<input type="checkbox"/>	1	<a href="#">3629161</a>	Electronic Control Module Wiring Harness	1	
<input type="checkbox"/>	2	<a href="#">S 103 D</a>	Hexagon Head Cap Screw	2	3/8 - 16 x 1 1/4 in.
<input type="checkbox"/>	3	<a href="#">S 604</a>	Lock Washer	2	3/8 in.
<input type="checkbox"/>	4	<a href="#">69911 A</a>	Clip	7	
<input type="checkbox"/>	5	<a href="#">70262</a>	Lock Washer	2	#6.
<input type="checkbox"/>	6	<a href="#">70310</a>	Pan Head Cap Screw	2	#6 - 32 X 3/8 Inch.
<input type="checkbox"/>	7	<a href="#">180371</a>	Clip	3	
<input type="checkbox"/>	8	<a href="#">3068528</a>	Clip	2	
<input type="checkbox"/>	9	<a href="#">3627719</a>	Wiring Brace	1	
<input type="checkbox"/>	10	<a href="#">108722</a>	Clip	2	

© 2019 Cummins Inc., Box 3005, Columbus, IN 47202-3005 U.S.A.  
Terms of Use and Disclaimers | Recommended System Requirements  
Need Assistance? Please click on the Contact Us button in the top right corner of any page.